



## DESCRIPTION

Insulfrax® Anchor-Loc3 Modules (bolting type) are manufactured from Insulfrax® S blankets to provide two standard construction forms, folded or edge stacked. These modules can be produced with various anchoring systems to enable quick, easy and efficient installation for most lining applications.

Available in a range of thickness and density combinations, the Insulfrax® module range is specifically designed to meet the thermal insulation requirements of industrial furnaces, kilns and heaters.

## GENERAL CHARACTERISTICS

Insulfrax® Anchor-Loc3 Module has the following outstanding characteristics :

- High temperature stability
- Low thermal conductivity & heat storage
- Resistance to thermal shock
- Central fixation system
- Easy installation & maintenance

## TYPICAL APPLICATIONS

- Fired heaters & Reformers
- Heat treatment Furnaces / CGL
- Ladle & Soaking pit covers
- HRSG & WHRU
- Tunnel kilns & Intermittent kilns

Any new and/or special use of these products, whether or not in an application listed in our literature, must be submitted to our technical department for their prior written approval.

*greener  
cleaner  
safer*  
specialty fibers for  
a greener, cleaner, safer world

**Unifrax India Private Limited** (Formerly Unifrax India Limited)

C-102, Business Square, Andheri-Kurla Road, Andheri (East), Mumbai-400 093

T:+91 (22) 2921 2200 / 201 | F:+91 (22) 2921 2249 | [unifrax.mumbai@unifrax.com](mailto:unifrax.mumbai@unifrax.com) | [www.unifrax.com](http://www.unifrax.com)

**UNIFRAX**

## TYPICAL PRODUCT PARAMETERS

Insulfrax® Anchor-Loc3 Module	
Typical Chemical Analysis (wt.%)	
CaO	27 - 33
MgO	2 - 7
SiO <sub>2</sub>	61 - 67
Al <sub>2</sub> O <sub>3</sub>	< 1
Fe <sub>2</sub> O <sub>3</sub>	< 0.6
Physical Properties	
Colour	White
Classification Temperature (°C)	1200
Use Limit (°C)	1050
Density (kg/m <sup>3</sup> )	128 / 160 / 192 Others on request

Classification Temperature is not a definition of the operational limit of these products, especially when long term physical or dimensional stability is a factor. For certain applications continuous use temperature limits may be significantly reduced. For assistance or clarification please contact your nearest Unifrax Engineering office.

## AVAILABILITY

Module Dimensions (mm)			AL3
Length	Width	Thickness	Per Carton
305	305	100	10
		125	8
		150	8
		175	6
		200	6
		225	4
		250	4
		275	4
		300	4

Other thicknesses / sizes may be available on request subject to minimum order requirements.

## ANCHOR ASSEMBLY

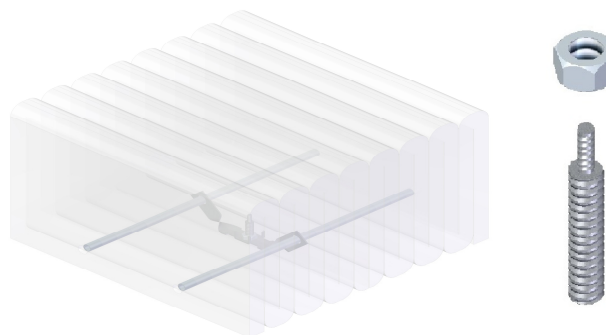

## THERMAL CONDUCTIVITY DATA ( W/mK)

Mean Temp. (°C)	Density (kg/m <sup>3</sup> )		
	128	160	192
400	0.12	0.11	0.11
600	0.16	0.15	0.14
800	0.21	0.18	0.17
1000	0.29	0.25	0.22

Thermal Conductivity figures are empirical values (average) based on experience.

## HANDLING INFORMATION

A Material Safety Data Sheet has been issued describing the health, safety and environmental properties of this product, identifying the potential hazards and giving advice on handling precautions and emergency procedures. This must be consulted and fully understood before handling, storage or use.

Supplied by:

Information contained in this publication is for illustrative purposes only and is not intended to create any contractual obligation. Further information and advice on specific details of the products described should be obtained in writing from a Unifrax Corporation company (Unifrax India). Unifrax maintains a continuous programme of product development and reserves the right to change product specifications without prior notice. Therefore, it maintains at all times the responsibility of the customer to ensure that Unifrax materials are suitable for the particular purpose intended. Similarly, insofar as materials not manufactured nor supplied by Unifrax are used in conjunction with or instead of Unifrax materials, the customer should ensure that all technical data and other information relating to such materials has been obtained from the manufacturer or supplier. Unifrax accepts no liability arising from the use of such materials. All sales made by a Unifrax Corporation company are subject to that company's Terms and Conditions of Sale, copies of which are available on request.